

Name	Vent	A
Typology	Side table	
Designer	Calen Knauf	



Description Vent's bold graphic quality is created by a linear array of offset aluminum slats, slightly inset into its oversized cylindrical base. The stark contrast between the two elements is softened through the table's uniform thickness and ultra-matte anodized finish.

Name

Vent

B

Material

Anodized, sand-blasted aluminum

Examples



20.2

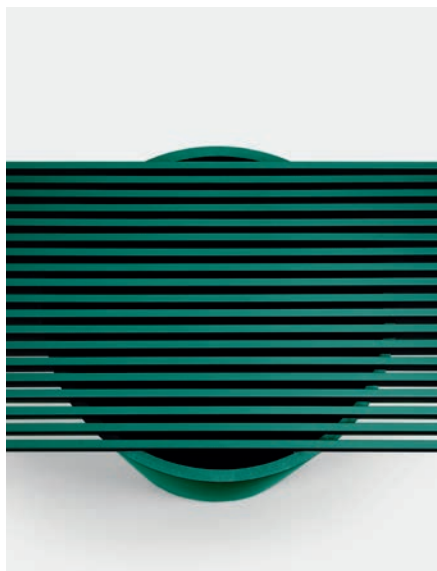

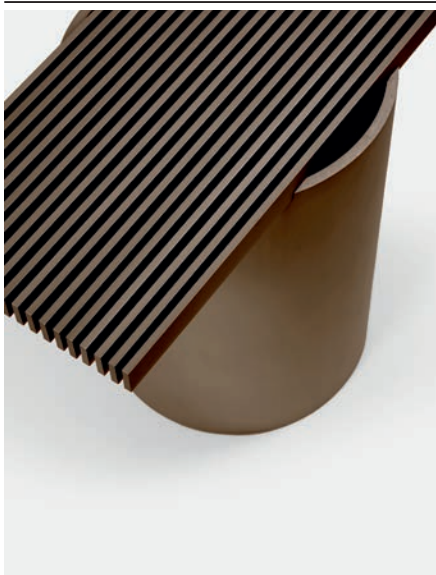

20.3



20.4

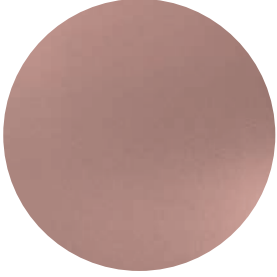

20.1

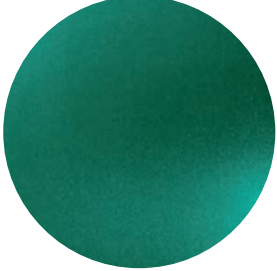
Name	Vent	C
Material	Anodized, sand-blasted aluminum	20
Colours	20.1 neutral	
		
	20.2 rose	
		
	20.3 umbra	
		
	20.4 green	
		

Name

Vent



Dimensions

46x26x40cm

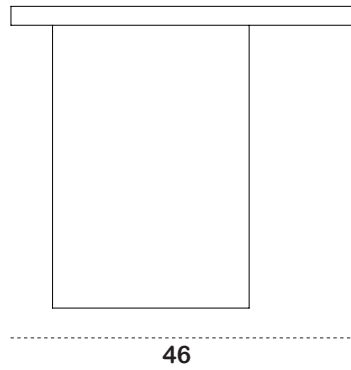
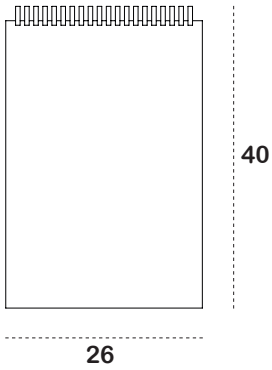
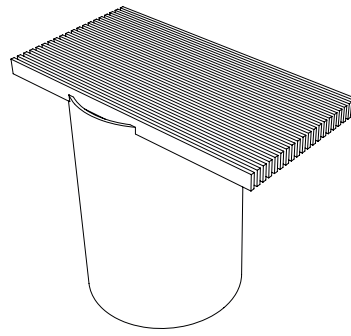
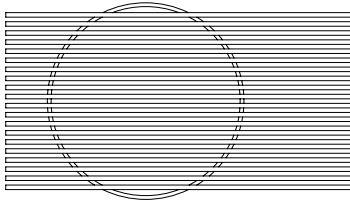

46x26x50cm

